



# COMPOSITE DECKING

## Installation Guide

Preparation of Installation	3-4
Expansion -Spacing Rules	5-6
Components	7
Getting Started - Installation	8
Installation - Continued	9-10
Finishing Off - Spotlights	11
Finishing Off	12

# Logical Decking



# Installation Guide

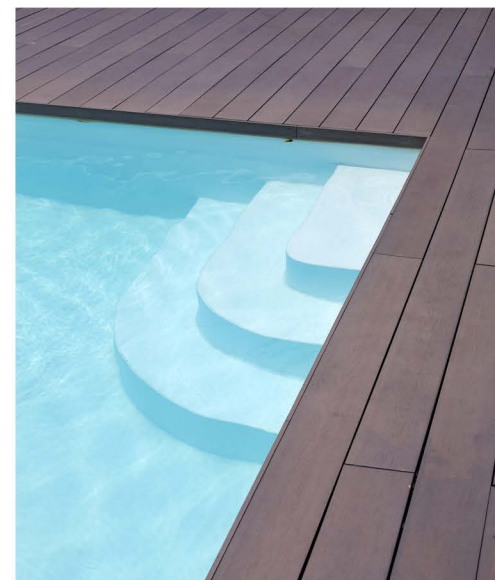



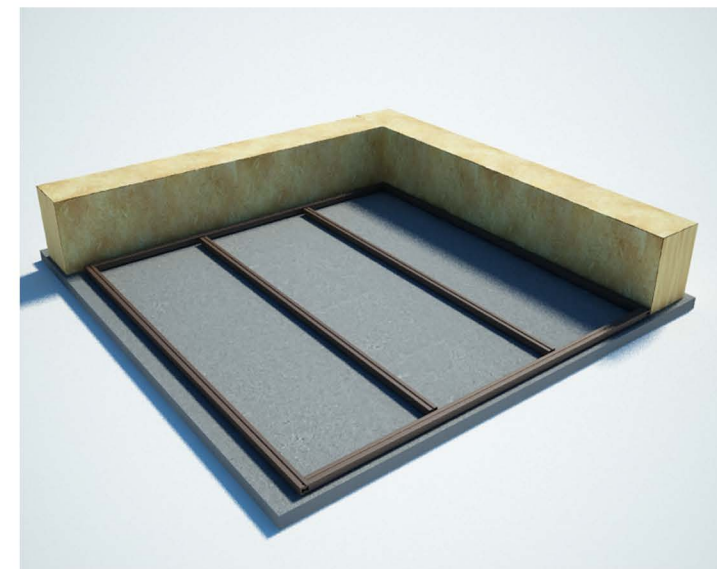
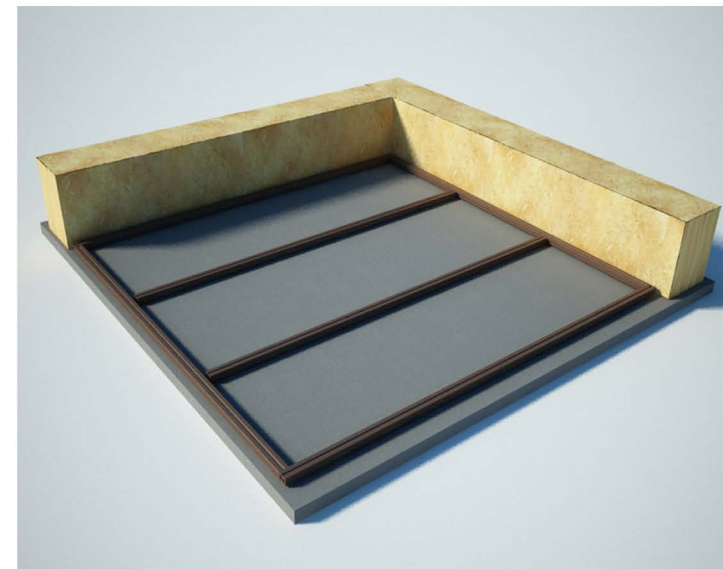
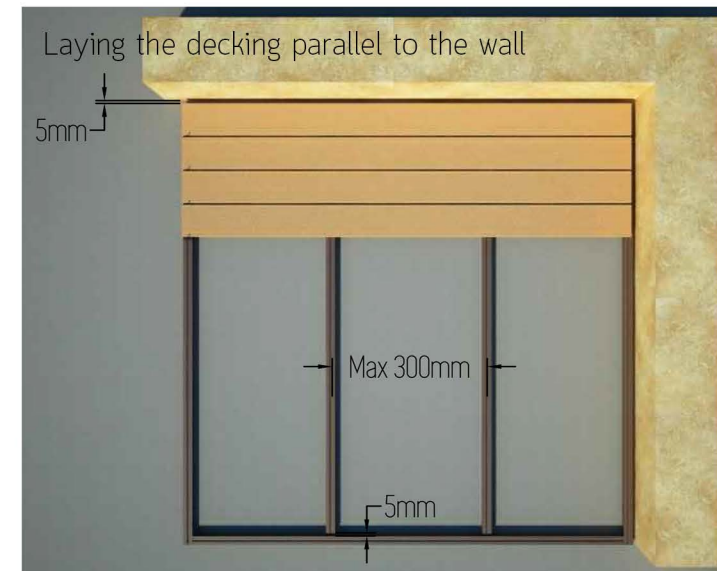
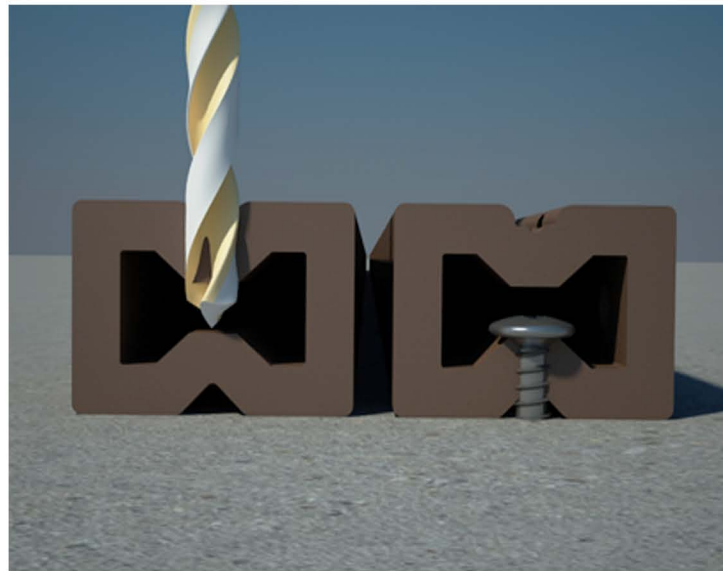
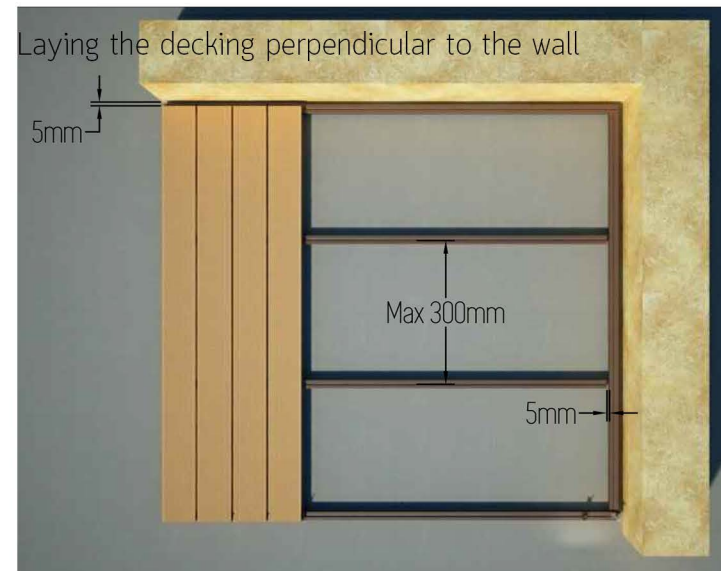

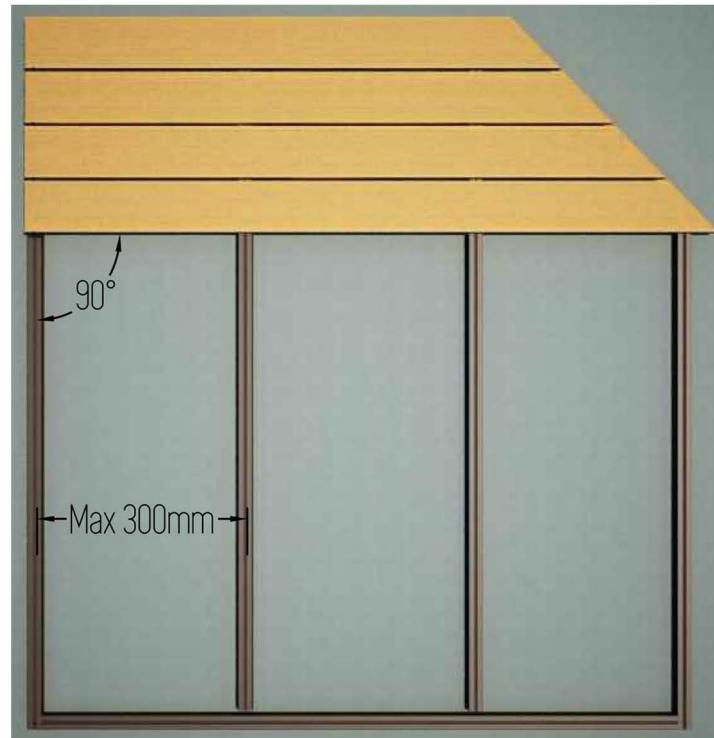

- Choose the decking design required, whether it is the standard vertical or horizontal or the herringbone / chevron design.
- Always use minimum 3 pieces of the bearer profile.
- For all applications where the bearer cannot be fully supported, you must use a solid structure made from other material i.e Wood, Metal etc .
- For elevated decks please ensure compliance with Building Regulations regarding structural calculations.



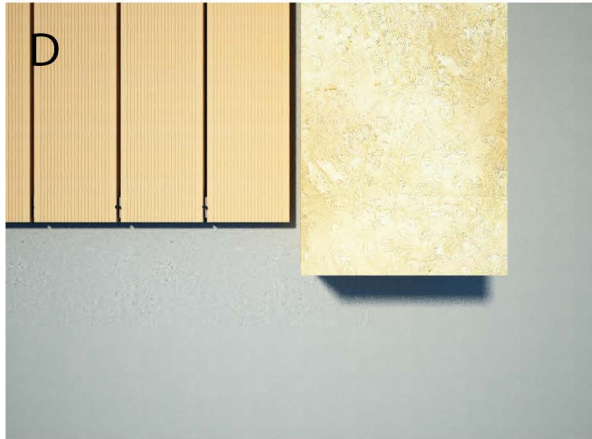
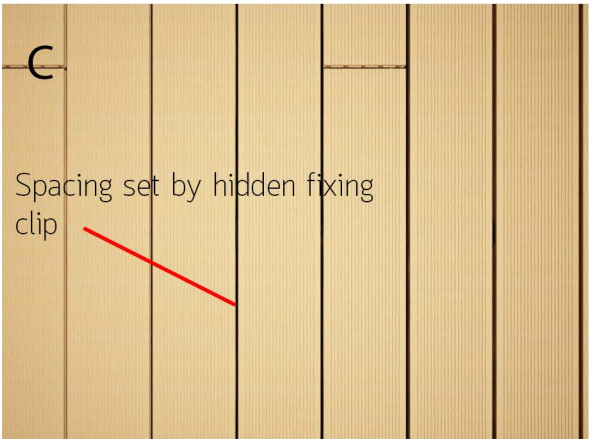
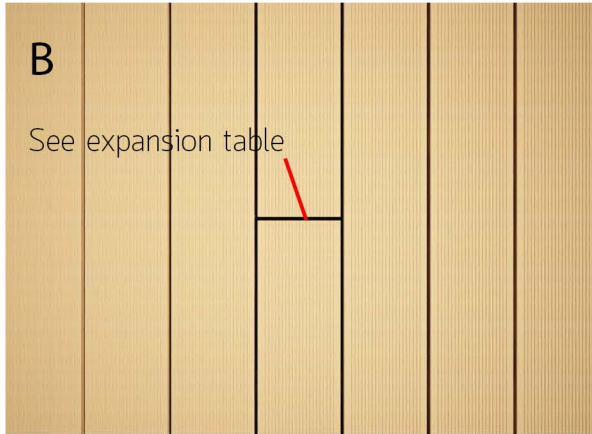
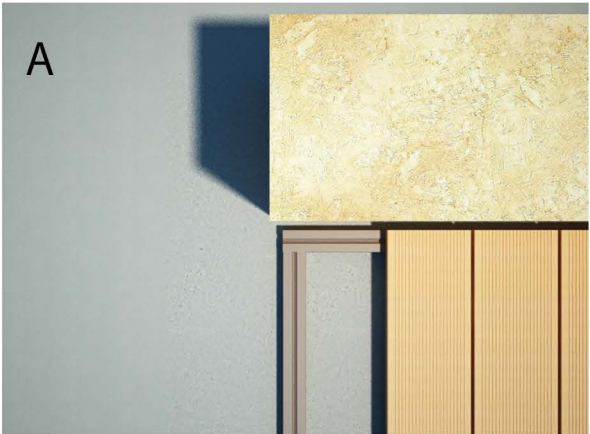
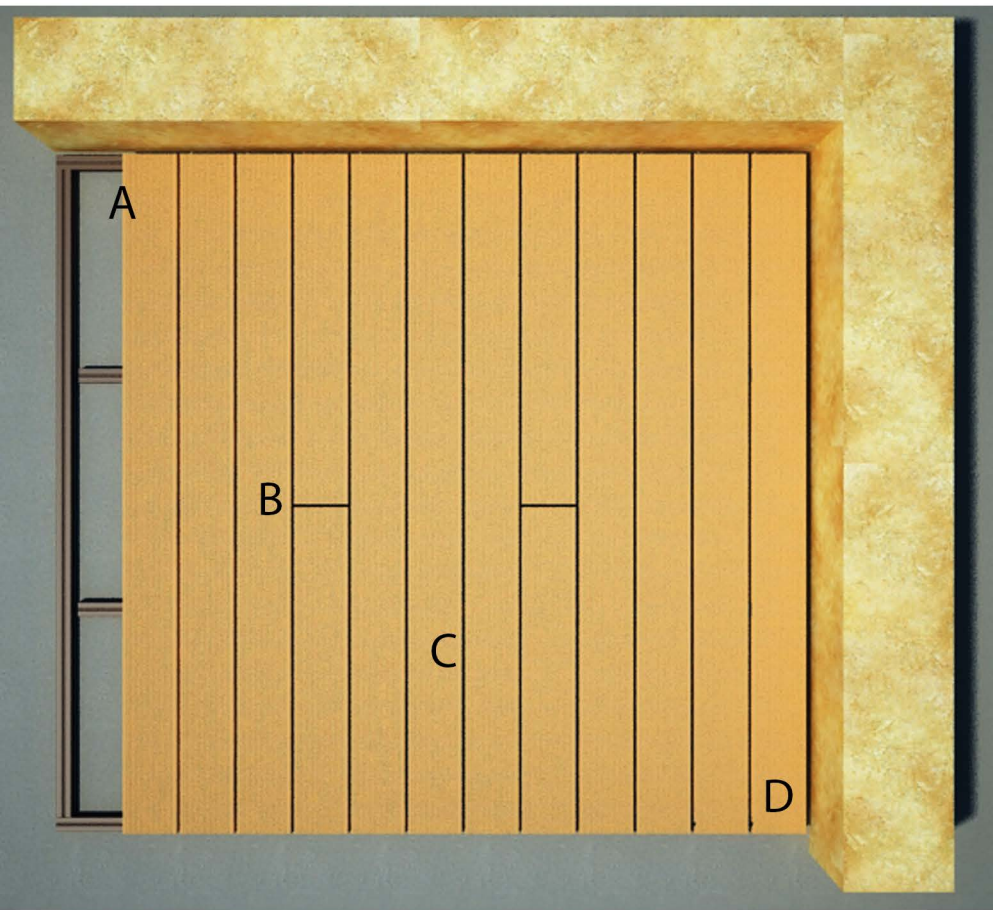

Temp Change of Board	Recommended minimum gap in mm between board ends for varying board lengths					
	1m Board	2m Board	3m Board	4m Board	5m Board	6m Board
20°	3	3	4	4	5	7
30°	3	3	4	4	5	7
40°	3	3	4	5	6	8
50°	3	3	4	5	6	8

All decking materials exhibit expansion and contraction over a range of temperatures. The table below gives recommended spacing between board ends based on board length and anticipated working temperature range of the installation.



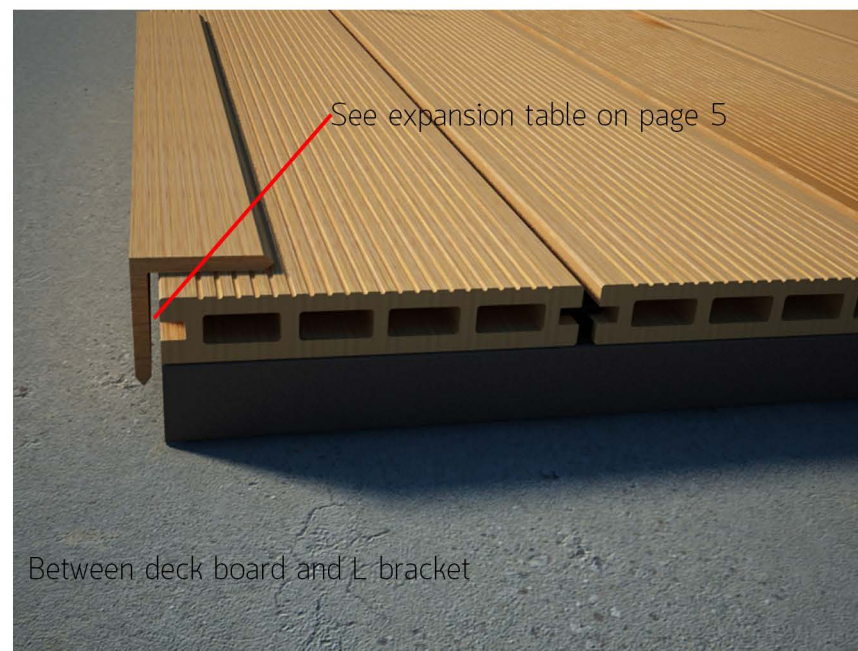
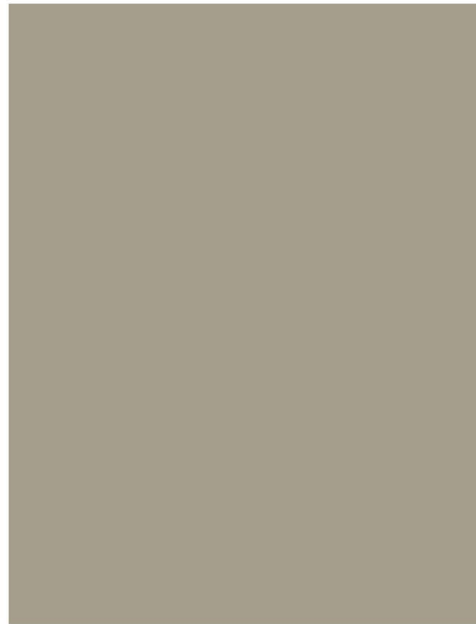
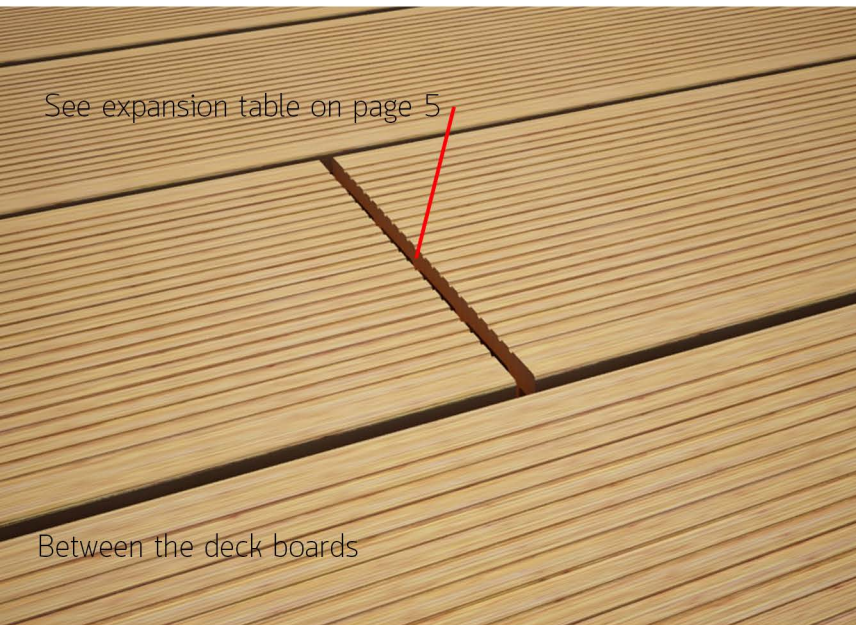

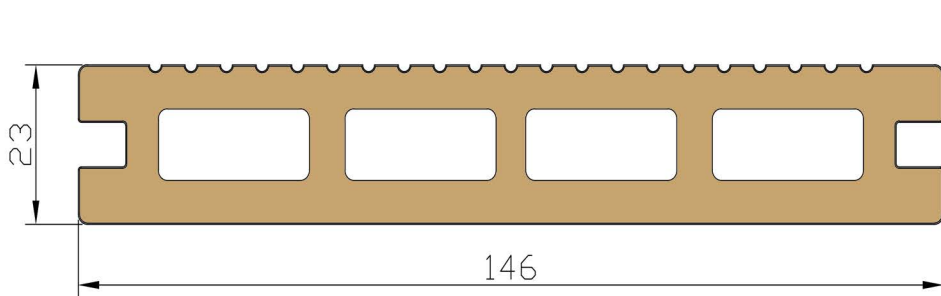

Decking Board

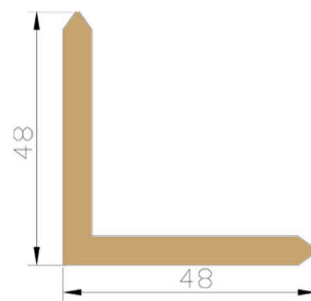

L Bracket

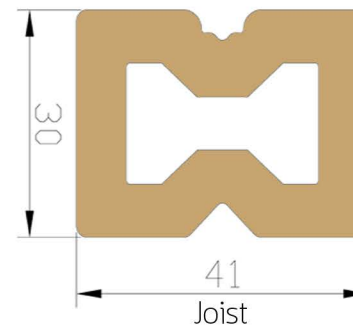

Joist



Stainless Steel Screw 30mm

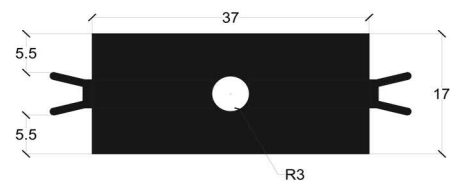

Hidden Deck Fastener

## Tools Required



Hand Drill



Spirit Level



Saw



Screw Driver

## Safety Equipment



Safety Goggles



Safety Gloves

## Material Storage

Store all materials in a warehouse and acclimatise 24 hours before installation takes place.

It is recommended that installation of Logical decking only takes place if the air temperature is 0°C or above.





Remember: Decide which orientation the decking will lay

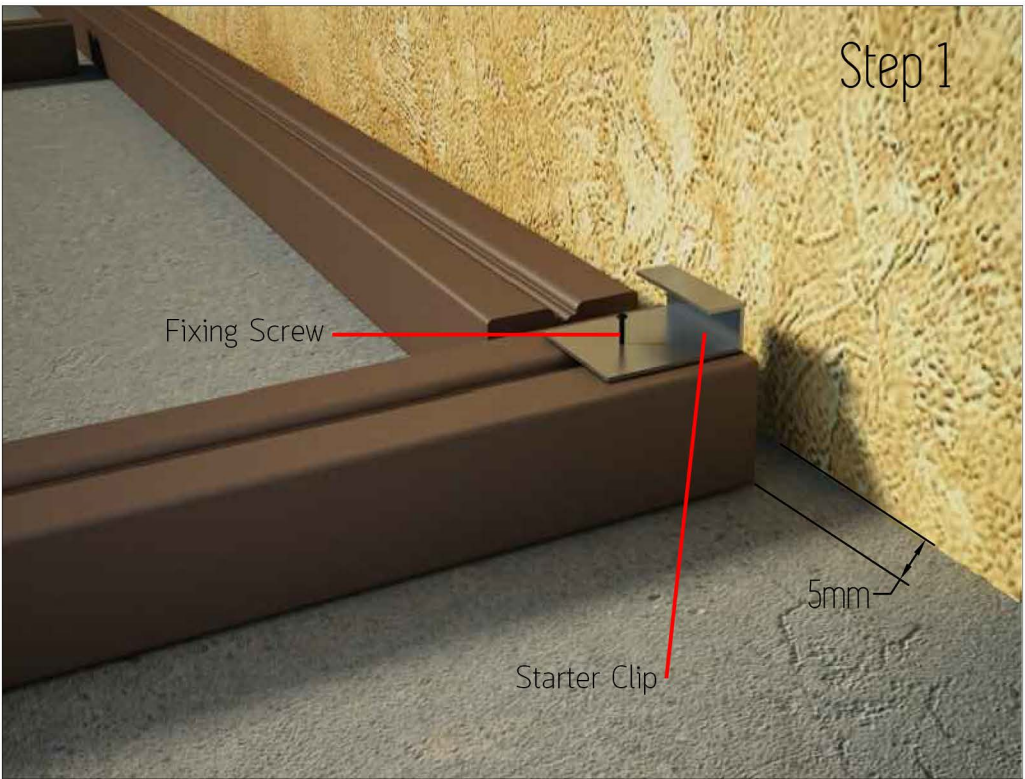



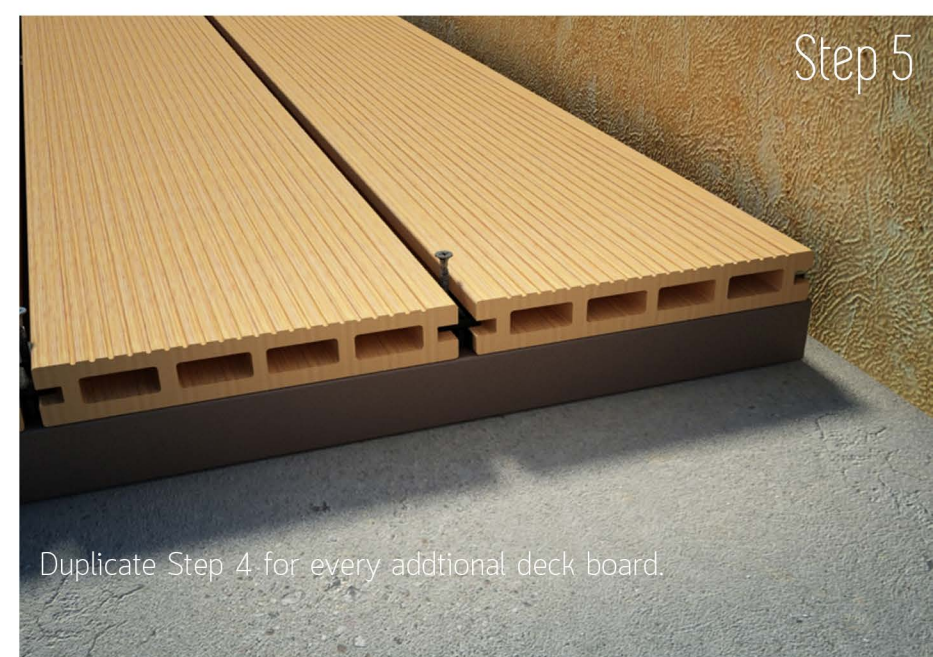
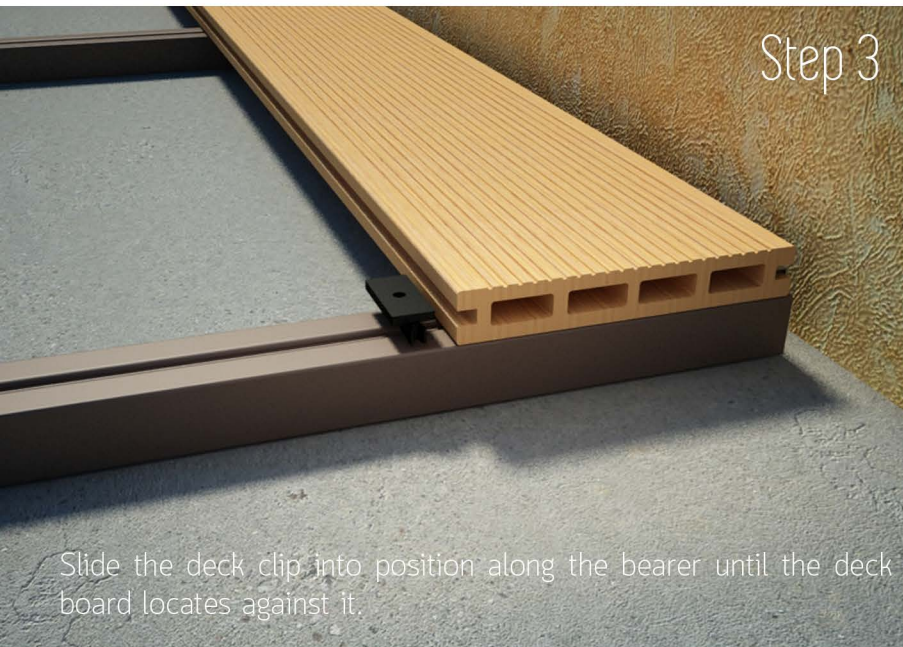



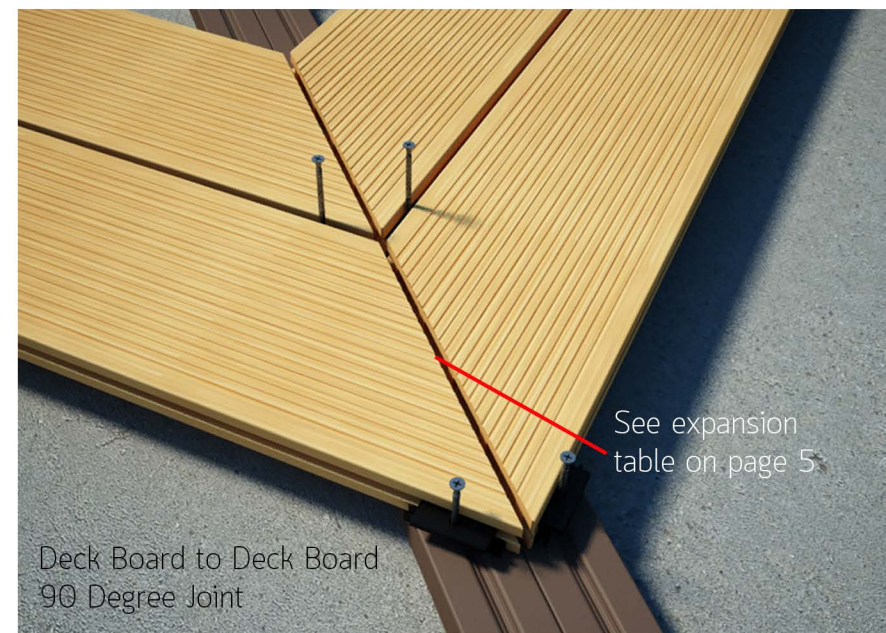
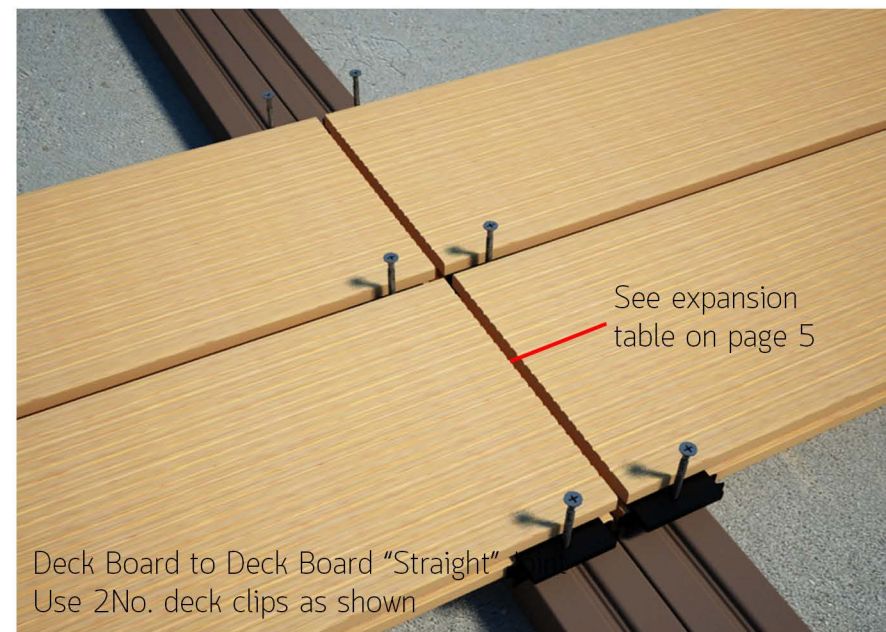
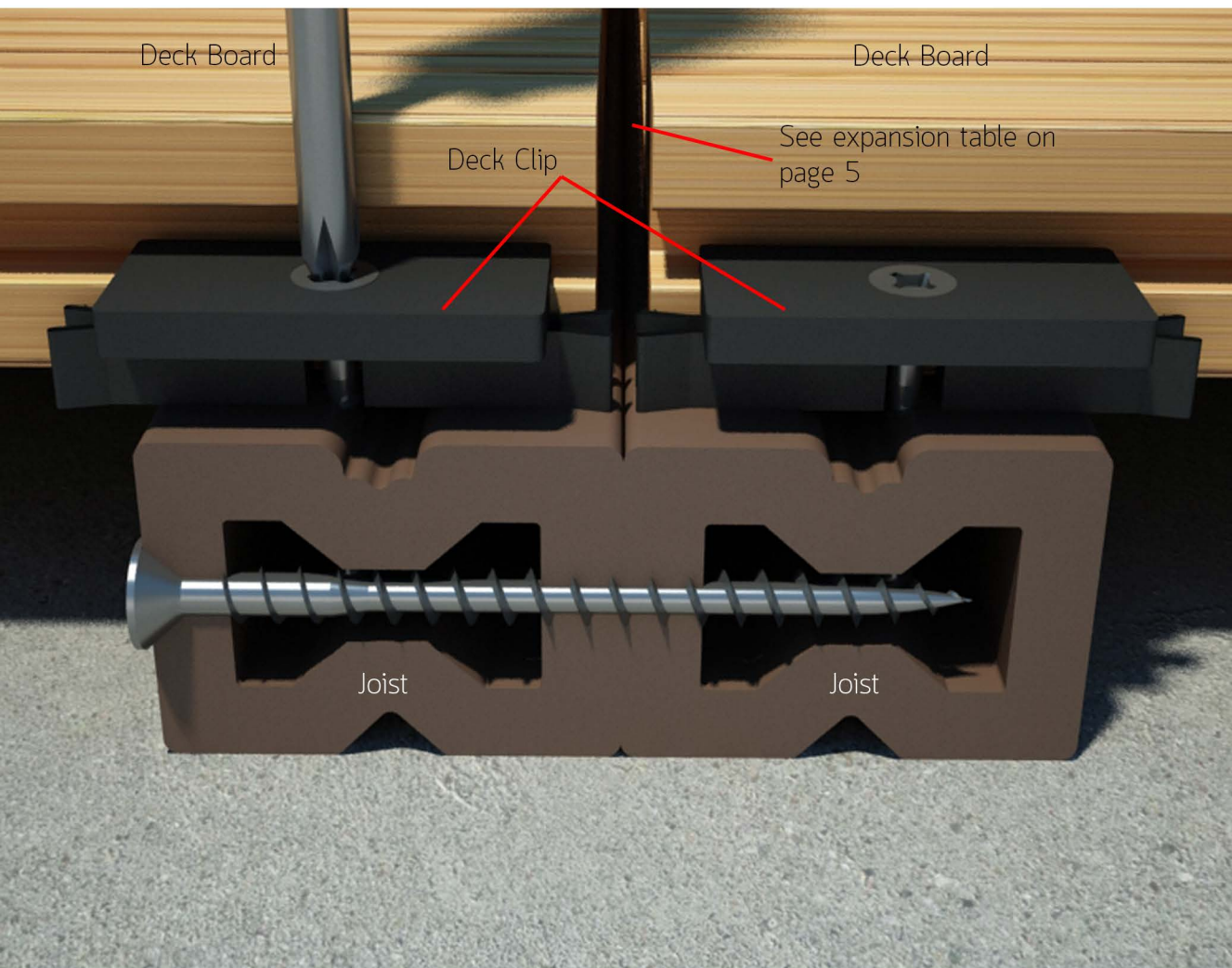



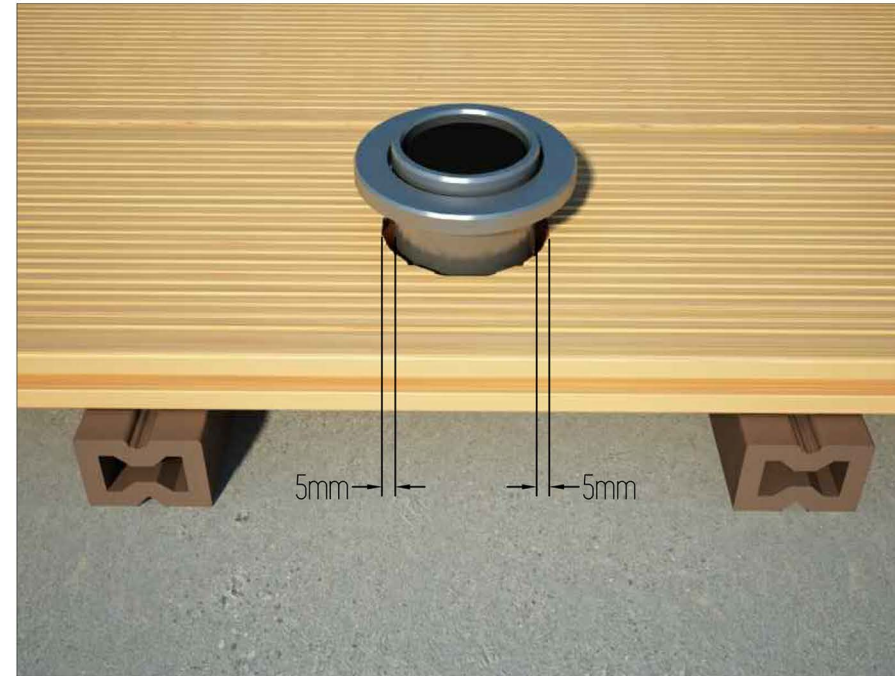
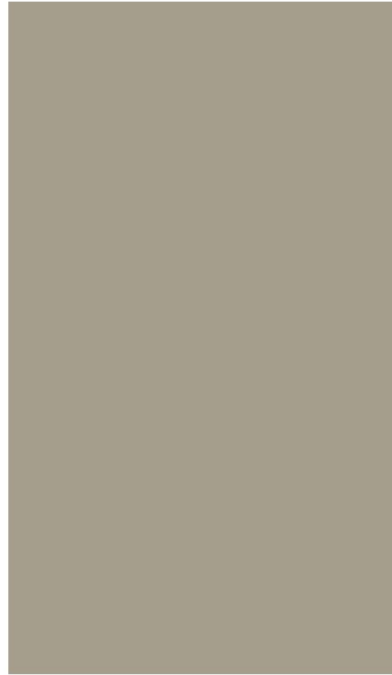
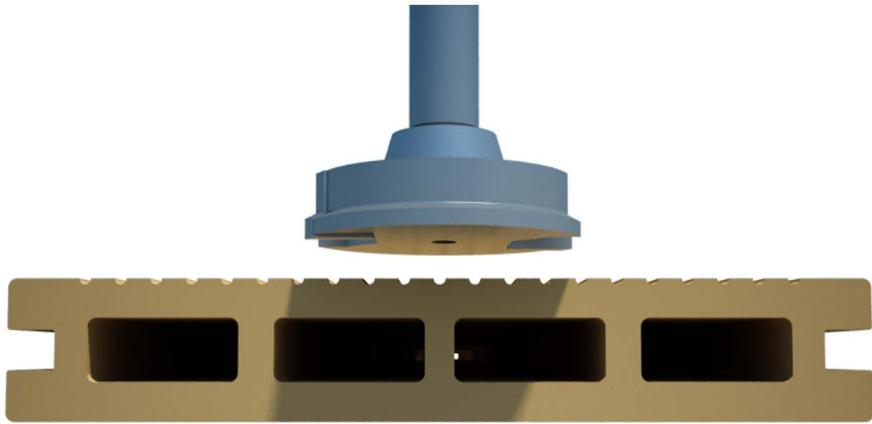

Always have the hole for the spotlights positioned centrally on the deck board.



Never position the spotlight between the joints of two deck boards.





Technical drawing of a beam with dimensions and saw cut locations. The beam has a total length of 115. The distance from the left end to the first saw cut is 53. The distance between the first and second saw cuts is 83.5. The distance between the second and third saw cuts is 8. The distance between the third and fourth saw cuts is 8. The distance between the fourth and fifth saw cuts is 8. The beam has a series of rectangular holes along its length.

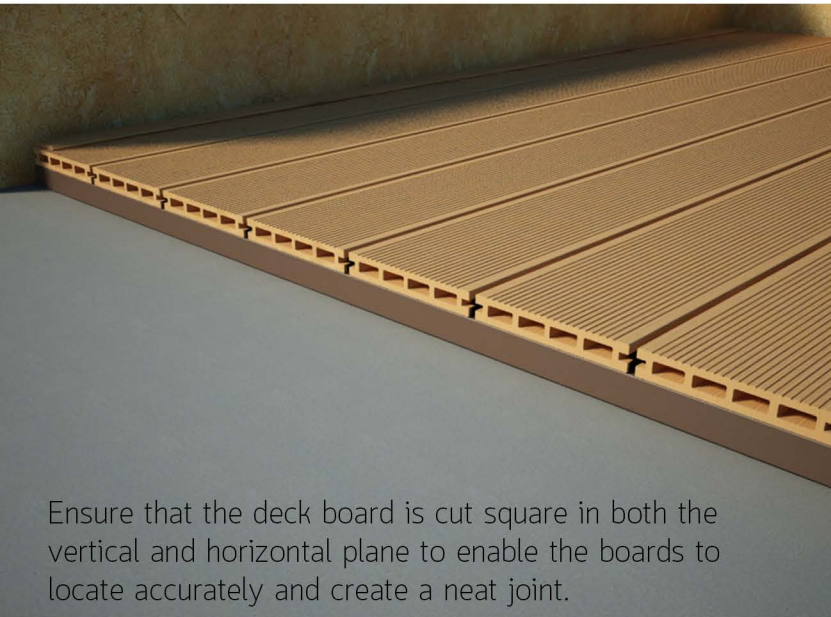

100

Using the finishing angle to finish off the perimeter of the deck, fix using screws at 300mm maximum centres directly into the Joist.



# Installation Guide





Logical Decking

Logical Plastic Industries  
European Business Center  
2nd Floor, Suite 200,  
Dubai Investments Park  
P.O. Box 282669  
Dubai,  
United Arab Emirates

Tel: +971 4 8856606  
Tel: +971 4 8135113  
Fax: +971 4 8135114

[info@logicaldecking.com](mailto:info@logicaldecking.com)  
[www.logicaldecking.com](http://www.logicaldecking.com)

